

p:\1048-2\Breezy point dock\CAD\SHEET\PERMIT-STATE\1048-2-STATE.dwg LOCATION MAP- 10/22/2015

STATE OF FLORIDA

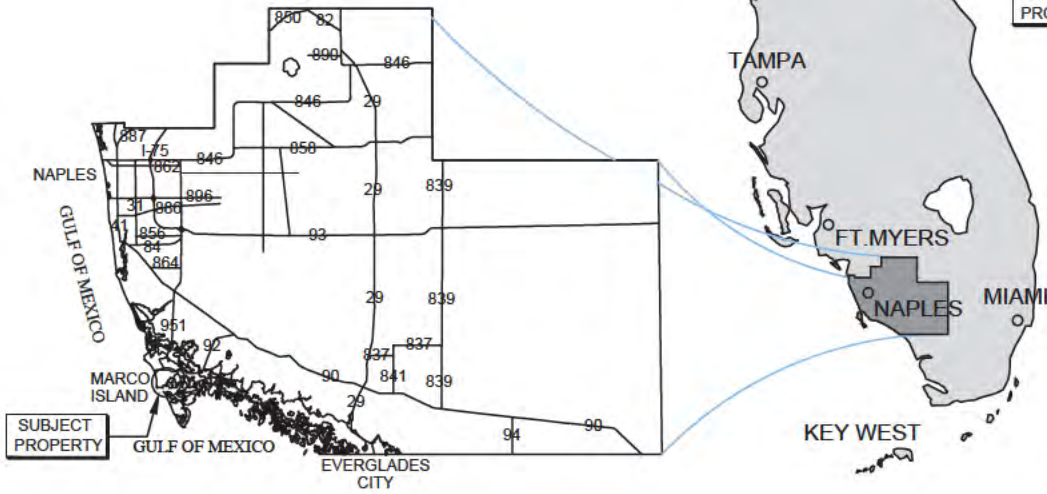

COLLIER COUNTY



VICINITY MAP



COUNTY AERIAL

SITE ADDRESS:
 <> 880 HURON CT
 MARCO ISLAND, FL 34145

NOTES:
 <> THESE DRAWINGS ARE FOR PERMITTING PURPOSES ONLY
 AND ARE NOT INTENDED FOR CONSTRUCTION USE.
 <> LATITUDE: N 25° 54' 63.016"
 <> LONGITUDE: W 81° 43' 22.376"

TODD T. TURRELL
 REGISTERED PROFESSIONAL ENGINEER
 FLORIDA REGISTRATION NO. 39659
 LICENSE NO. 5875
 DATE: Oct 22, 2015 8:50:11

RECEIVED November 19, 2015
 South District DEP



Turrell, Hall & Associates, Inc.
 Marine & Environmental Consulting
 3584 Exchange Ave. Suite B. Naples, FL 34104-3732

Email: tuna@turrell-associates.com Phone: (239) 643-0166 Fax: (239) 643-6632

BREEZY POINT LOCATION MAP

THESE DRAWINGS ARE FOR PERMITTING PURPOSES ONLY AND ARE NOT INTENDED FOR CONSTRUCTION USE.

DESIGNED:	JWM	REV#	REV BY	DATE	CHK BY	CHANGED
DRAWN BY:	RMJ	1.	-	-	-	-
CREATED:	05-07-15	2.	-	-	-	-
JOB NO.:	1048.1	3.	-	-	-	-
SHEET NO.:	01 OF 07	4.	-	-	-	-
		5.	-	-	-	-

SECTION-18 TOWNSHIP- 52S RANGE- 26E

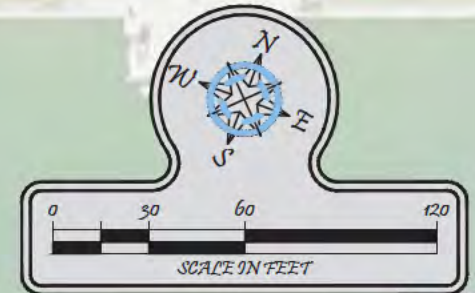

RECEIVED November 19, 2015
South District DEP

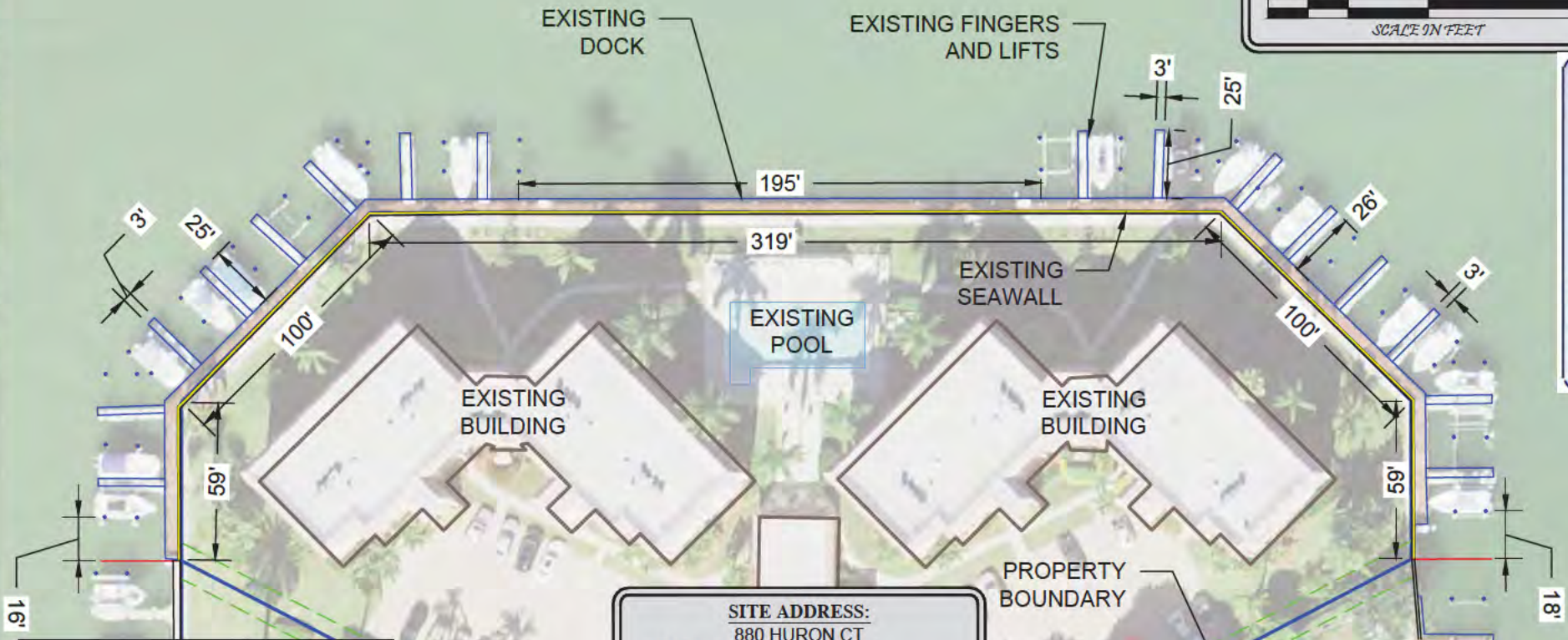

SITE ADDRESS:
880 HURON CT
MARCO ISLAND, FL 34145

TODD T. TURRELL
REGISTERED PROFESSIONAL ENGINEER
FLORIDA REGISTRATION NO. 39659
LICENSE NO. 5875
DATE: Oct 22, 2015 8:50:15

CLASS	LENGTH (LOA)	BEAM (MAX)	SLIPS
A	25	VARIES	32
TOTAL			32

NOTES:

- THESE DRAWINGS ARE FOR PERMITTING PURPOSES ONLY AND ARE NOT INTENDED FOR CONSTRUCTION USE.
- ALL DATUM SHOWN HEREON IS REFERENCED TO MLW
- SURVEY COURTESY OF: "COURT GREGORY SURVEYING, INC."
- SURVEY DATED: 06-03-15
- APPLICANT OWNED SHORELINE (APPX LF): 637.18'
- EXISTING OVERWATER STRUCTURE (APPX SF): 4,338
- WIDTH OF WATERWAY, MHW TO MHW (APPX): 94
- TIDAL DATUM:
 - MLW (NAVD)= -1.8"
 - MHW (NAVD)= +0.4"



Turrell, Hall & Associates, Inc.
Marine & Environmental Consulting
3584 Exchange Ave. Suite B. Naples, FL 34104-3732
Email: tuna@turrell-associates.com Phone: (239) 643-0166 Fax: (239) 643-6632

BREEZY POINT
EXISTING AERIAL

DESIGNED:	JWM	REV	REV BY	DATE	CHK BY	CHANGED
DRAWN BY:	RMJ	1.	-	-	-	-
CREATED:	05-07-15	2.	-	-	-	-
JOB NO.:	1048.1	3.	-	-	-	-
SHEET NO.:	02	4.	-	-	-	-
		5.	-	-	-	-

SECTION- 18 TOWNSHIP- 52 S RANGE- 26 E

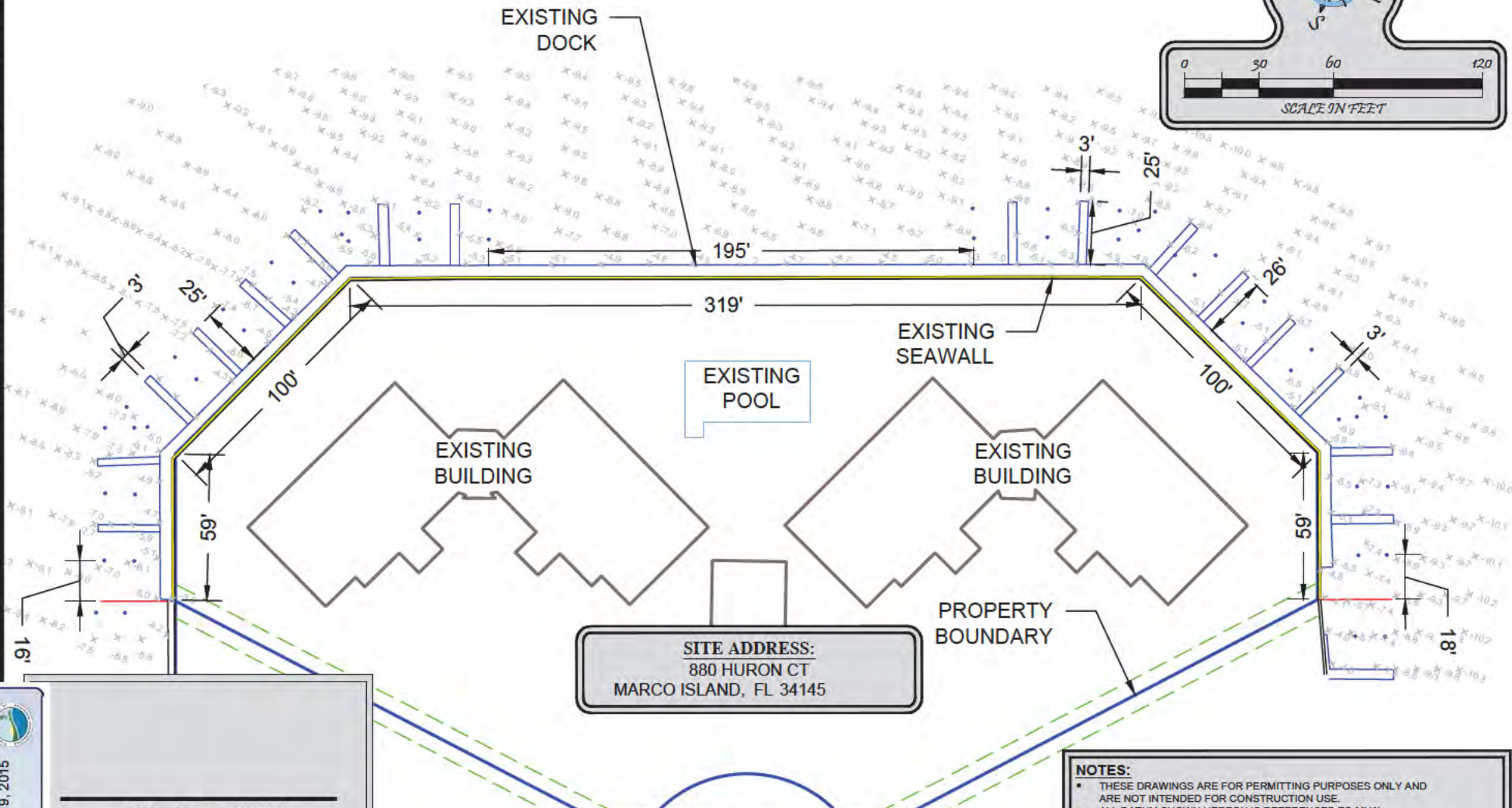
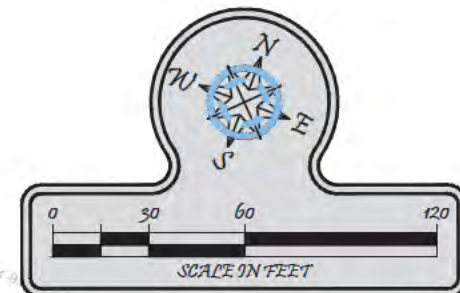

SITE ADDRESS:
880 HURON CT
MARCO ISLAND, FL 34145

- NOTES:**
- THESE DRAWINGS ARE FOR PERMITTING PURPOSES ONLY AND ARE NOT INTENDED FOR CONSTRUCTION USE.
 - ALL DATUM SHOWN HEREON IS REFERENCED TO MLW
 - SURVEY COURTESY OF: "COURT GREGORY SURVEYING, INC."
 - SURVEY DATED: 06-03-15
 - APPLICANT OWNED SHORELINE (APPX LF): 637.18'
 - EXISTING OVERWATER STRUCTURE (APPX SF): 4,338
 - WIDTH OF WATERWAY, MHW TO MHW (APPX): 94
 - TIDAL DATUM:
 - MLW (NAVD)= -1.8"
 - MHW (NAVD)= +0.4"

CLASS	LENGTH (LOA)	BEAM (MAX)	SLIPS
A	25	VARIES	32
TOTAL			32

TODD T. TURRELL
REGISTERED PROFESSIONAL ENGINEER
FLORIDA REGISTRATION NO. 39659
LICENSE NO. 5875
DATE: Oct 22, 2015 8 50:19

RECEIVED November 19, 2015
South District DEP



Turrell, Hall & Associates, Inc.
Marine & Environmental Consulting
3584 Exchange Ave. Suite B. Naples, FL 34104-3732
Email: tuna@turrell-associates.com Phone: (239) 643-0166 Fax: (239) 643-6632

BREEZY POINT EXISTING SITE

DESIGNED BY:	JWM	REV#	REV BY:	DATE	CHK BY:	CHANGED
DRAWN BY:	RMJ	1.	-	-	-	-
CREATED:	05-07-15	2.	-	-	-	-
JOB NO.:	1048.1	3.	-	-	-	-
SHEET NO.:	03	4.	-	-	-	-
		5.	-	-	-	-

SECTION-18 TOWNSHIP-52S RANGE-26E

THESE DRAWINGS ARE FOR PERMITTING PURPOSES ONLY AND ARE NOT INTENDED FOR CONSTRUCTION USE.

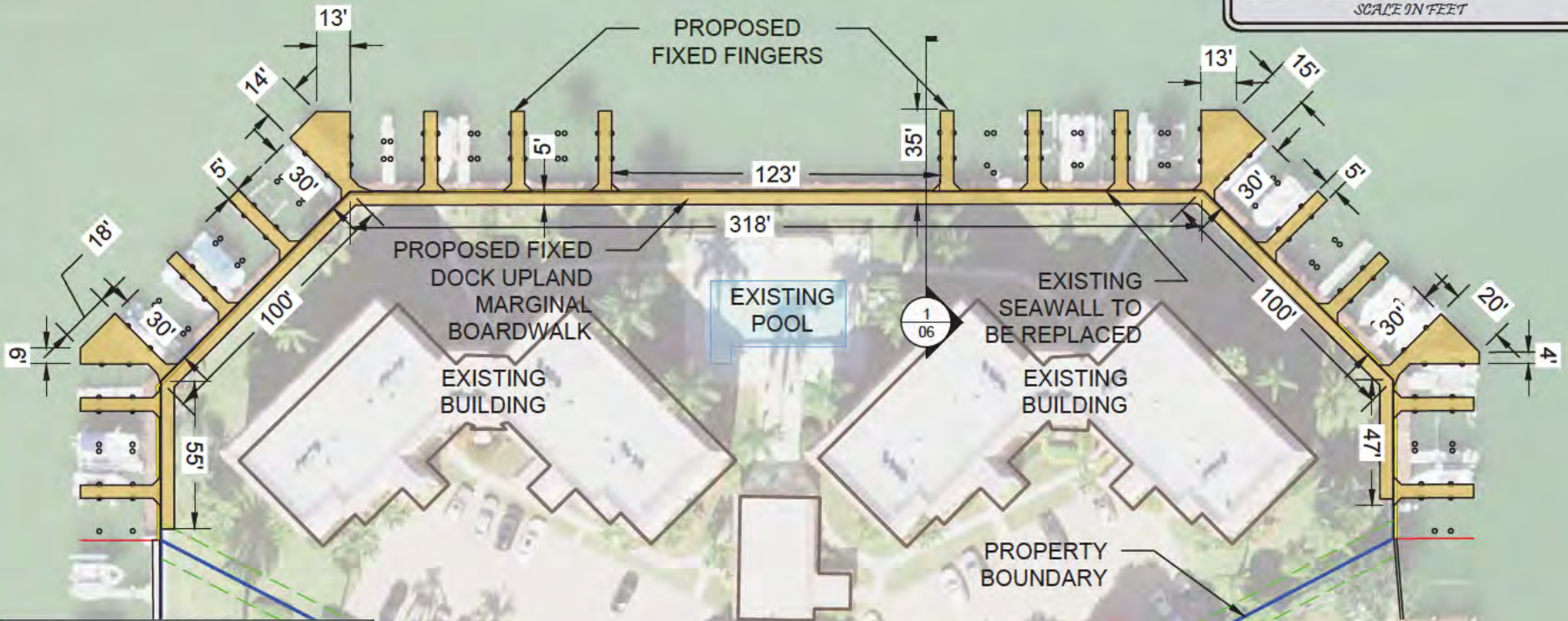
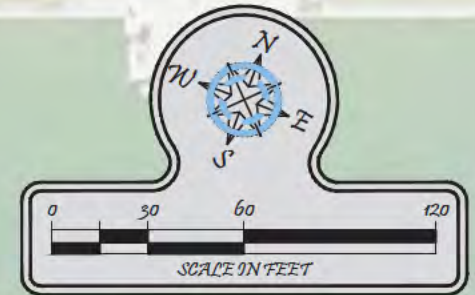

- NOTES:**
- THESE DRAWINGS ARE FOR PERMITTING PURPOSES ONLY AND ARE NOT INTENDED FOR CONSTRUCTION USE.
 - ALL DATUM SHOWN HEREON IS REFERENCED TO MLW
 - SURVEY COURTESY OF: "COURT GREGORY SURVEYING, INC."
 - SURVEY DATED: 06-03-15
 - APPLICANT OWNED SHORELINE (APPX LF): 637.18'
 - EXISTING OVERWATER STRUCTURE (APPX SF): 4,338
 - WIDTH OF WATERWAY, MHW TO MHW (APPX): 94
 - TIDAL DATUM:
 - MLW (NAVD)= -1.8"
 - MHW (NAVD)= +0.4"
 - PROPOSED OVERWATER STRUCTURE (APPX SF): 3,913
 - TOTAL OVERWATER STRUCTURE (APPX SF): 3,913
 - TOTAL PROTRUSION FROM MHWL: 30

CLASS	LENGTH (LOA)	BEAM (MAX)	SLIPS
A	30	12.5	32
TOTAL			32

DESIGNED:	JWM	REV	REV BY	DATE	CHK BY	CHANGED
DRAWN BY:	RMJ	1.	-	-	-	-
CREATED:	05-07-15	2.	-	-	-	-
JOB NO.:	1048.1	3.	-	-	-	-
SHEET NO.:	04 OF 07	4.	-	-	-	-
		5.	-	-	-	-

SECTION- 18 TOWNSHIP- 52 S RANGE- 26 E

RECEIVED November 19, 2015
 South District DEP

TODD T. TURRELL
 REGISTERED PROFESSIONAL ENGINEER
 FLORIDA REGISTRATION NO. 39659
 LICENSE NO. 5875
 DATE: Oct 22, 2015 8:50:24

Turrell, Hall & Associates, Inc.
 Marine & Environmental Consulting
 3584 Exchange Ave. Suite B. Naples, FL 34104-3732
 Phone: (239) 643-0166 Fax: (239) 643-6632

BREEZY POINT

PROPOSED AERIAL

THESE DRAWINGS ARE FOR PERMITTING PURPOSES ONLY AND ARE NOT INTENDED FOR CONSTRUCTION USE.

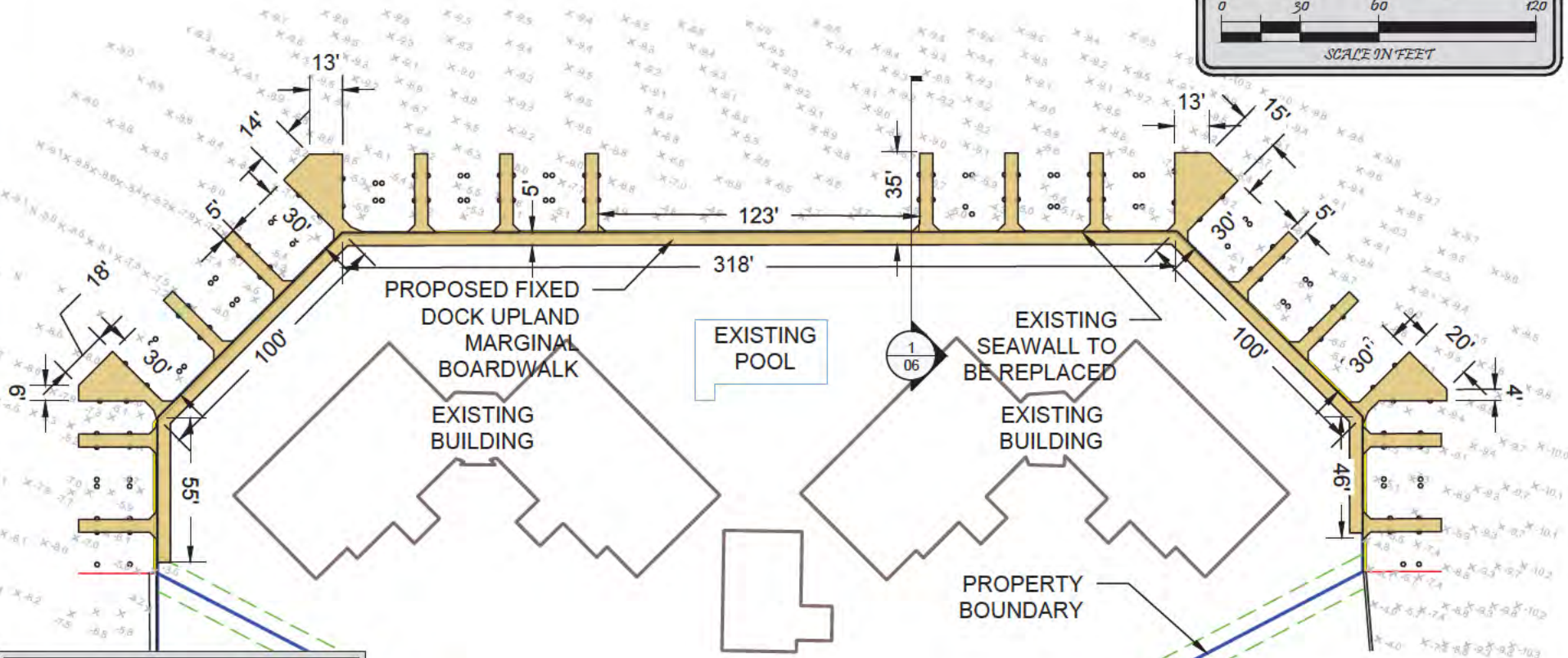
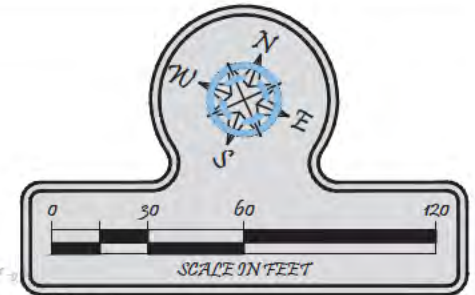

NOTES:

- THESE DRAWINGS ARE FOR PERMITTING PURPOSES ONLY AND ARE NOT INTENDED FOR CONSTRUCTION USE.
- ALL DATUM SHOWN HEREON IS REFERENCED TO MLW
- SURVEY COURTESY OF: "COURT GREGORY SURVEYING, INC."
- SURVEY DATED: 06-03-15
- APPLICANT OWNED SHORELINE (APPX LF): 637.18'
- EXISTING OVERWATER STRUCTURE (APPX SF): 4,338
- WIDTH OF WATERWAY, MHW TO MHW (APPX): 94
- TIDAL DATUM:
 - MLW (NAVD)= -1.8"
 - MHW (NAVD)= +0.4"
- PROPOSED OVERWATER STRUCTURE (APPX SF): 3,913
- TOTAL OVERWATER STRUCTURE (APPX SF): 3,913
- TOTAL PROTRUSION FROM MHWL: 30

TODD T. TURRELL
 REGISTERED PROFESSIONAL ENGINEER
 FLORIDA REGISTRATION NO. 39659
 LICENSE NO. 5875
 DATE: Oct 22, 2015 8:50:29

CLASS	LENGTH (LOA)	BEAM (MAX)	SLIPS
A	30	12.5	32
TOTAL			32

RECEIVED November 19, 2015
 South District DEP



Turrell, Hall & Associates, Inc.
 Marine & Environmental Consulting
 3584 Exchange Ave. Suite B. Naples, FL 34104-3732
 il: tuna@turrell-associates.com Phone: (239) 643-0166 Fax: (239) 643-6632

BREEZY POINT PROPOSED SITE

DESIGNED:	JWM	REV	REV BY	DATE	CHK BY	CHANGED
DRAWN BY:	RMJ	1.	-	-	-	-
CREATED:	05-07-15	2.	-	-	-	-
JOB NO.:	1048.1	3.	-	-	-	-
SHEET NO.:	05 OF 07	4.	-	-	-	-
		5.	-	-	-	-

SECTION-18 TOWNSHIP-52 S RANGE-26 E

THESE DRAWINGS ARE FOR PERMITTING PURPOSES ONLY AND ARE NOT INTENDED FOR CONSTRUCTION USE.

P:\1048.2-Breezy Point Dock\CAD\SHEET\PERMIT\STATE\1048.2-STATE.dwg TYPICAL DOCK SECTION 11/18/2015

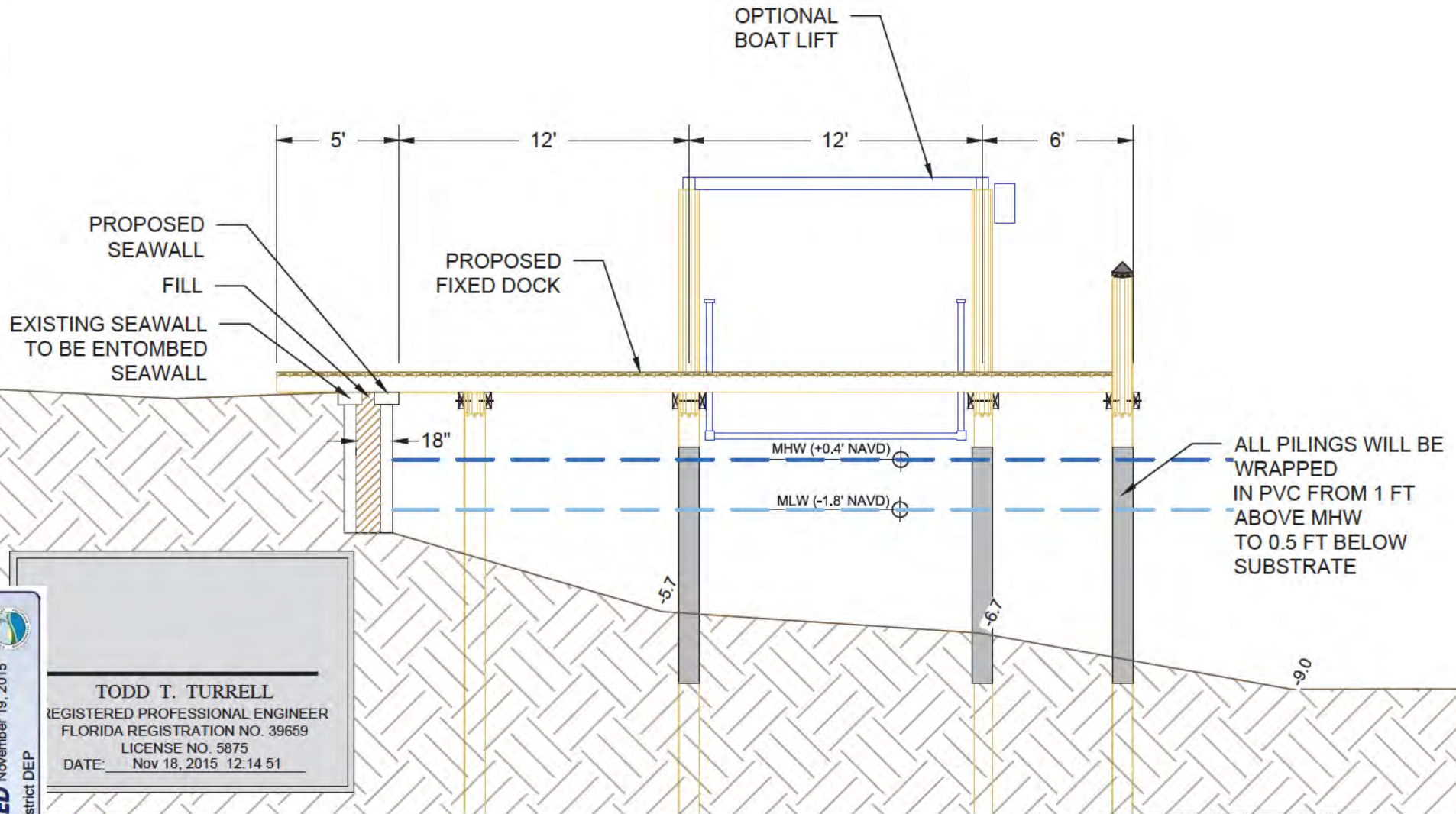
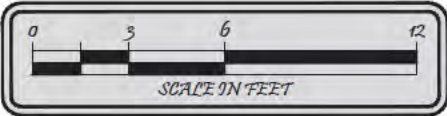

RECEIVED November 19, 2015
South District DEP

TODD T. TURRELL
REGISTERED PROFESSIONAL ENGINEER
FLORIDA REGISTRATION NO. 39659
LICENSE NO. 5875
DATE: Nov 18, 2015 12:14 51

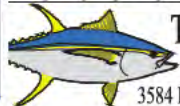

Turrell, Hall & Associates, Inc.
Marine & Environmental Consulting
3584 Exchange Ave. Suite B. Naples, FL 34104-3732

BREEZY POINT
TYPICAL DOCK SECTION

DESIGNED BY:	JWM	REV	REV BY	DATE	CHK BY	CHANGED
DRAWN BY:	RMJ	1.	-	-	-	-
CREATED:	05-07-15	2.	-	-	-	-
JOB NO.:	1048.1	3.	-	-	-	-
SHEET NO.:	06 OF 07	4.	-	-	-	-
		5.	-	-	-	-

SECTION-18 TOWNSHIP-52 S RANGE-26 E

THESE DRAWINGS ARE FOR PERMITTING PURPOSES ONLY AND ARE NOT INTENDED FOR CONSTRUCTION USE.

Email: tuna@turrell-associates.com Phone: (239) 643-0166 Fax: (239) 643-6632

p11048.2-breezy point dock\CAD\SH-EN\PERMIT-STATE\1048.2-STATE.dwg 5/8/2015 10:29:2015

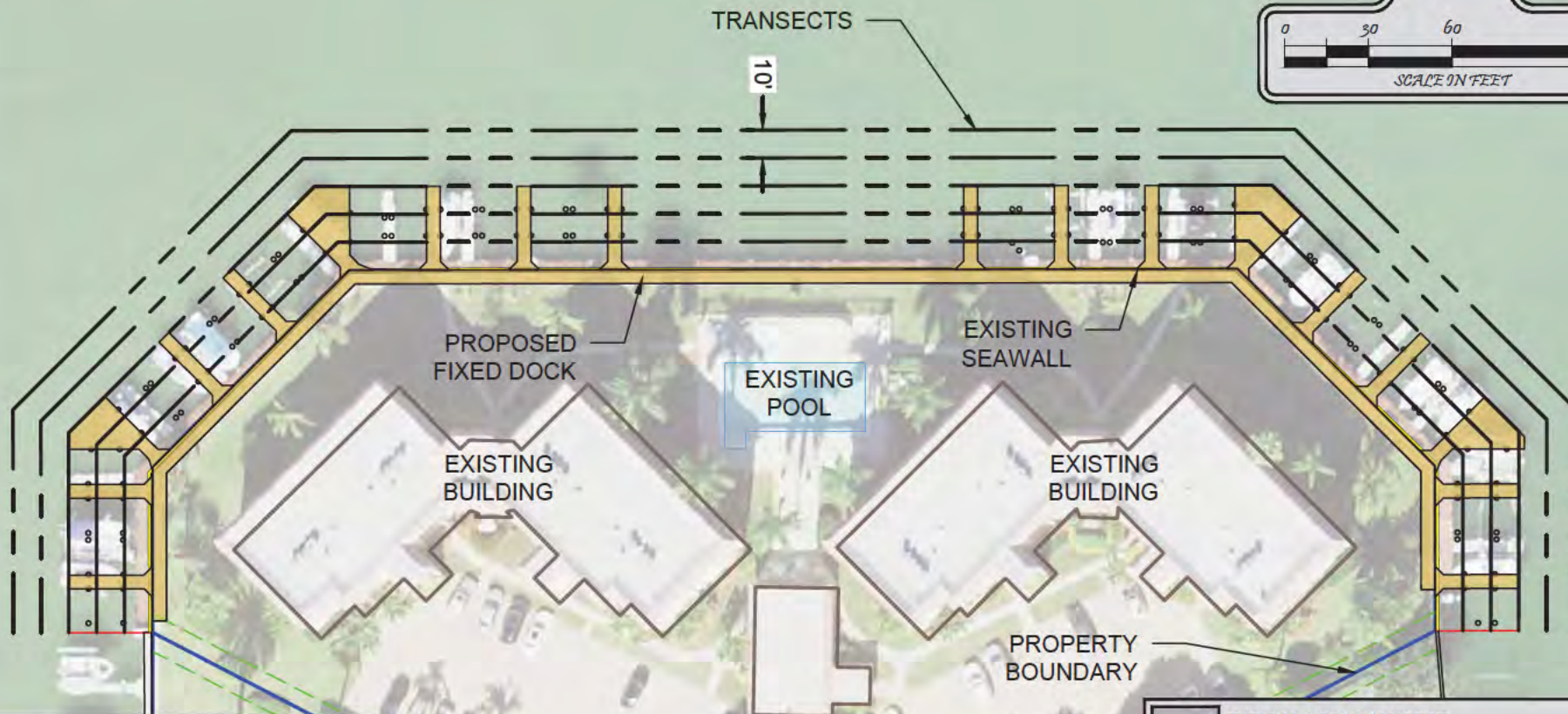
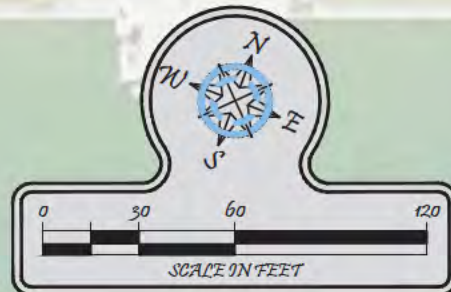

TODD T. TURRELL
 REGISTERED PROFESSIONAL ENGINEER
 FLORIDA REGISTRATION NO. 39659
 LICENSE NO. 5875
 DATE: Oct 22, 2015 8:50:39

CLASS	LENGTH (LOA)	BEAM (MAX)	SLIPS
A	30	12.5	32
TOTAL			32

TYPICAL DIVE TRANSECT

NOTES:

- THESE DRAWINGS ARE FOR PERMITTING PURPOSES ONLY AND ARE NOT INTENDED FOR CONSTRUCTION USE.
- ALL DATUM SHOWN HEREON IS REFERENCED TO MLW
- SURVEY COURTESY OF: "COURT GREGORY SURVEYING, INC."
- SURVEY DATED: 06-03-15
- APPLICANT OWNED SHORELINE (APPX LF): 637.18'
- EXISTING OVERWATER STRUCTURE (APPX SF): 4,338
- WIDTH OF WATERWAY, MHW TO MHW (APPX): 94
- TIDAL DATUM:
 - MLW (NAVD)= -1.8"
 - MHW (NAVD)= +0.4"
- PROPOSED OVERWATER STRUCTURE (APPX SF): 3,913
- TOTAL OVERWATER STRUCTURE (APPX SF): 3,913
- TOTAL PROTRUSION FROM MHWL: 30

RECEIVED November 19, 2015
South District DEP



Turrell, Hall & Associates, Inc.
 Marine & Environmental Consulting
 3584 Exchange Ave. Suite B. Naples, FL 34104-3732

Email: tuna@turrell-associates.com Phone: (239) 643-0166 Fax: (239) 643-6632

BREEZY POINT

SUBMERGED RESOURCE SURVEY

DESIGNED:	JWM	REV	REV BY	DATE	CHK BY	CHANGED
DRAWN BY:	RMJ	1.	-	-	-	-
CREATED:	10-22-15	2.	-	-	-	-
JOB NO.:	1048.1	3.	-	-	-	-
SHEET NO.:	07 OF 07	4.	-	-	-	-
5.	-	-	-	-	-	-

SECTION-18 TOWNSHIP-52 S RANGE-26 E

THESE DRAWINGS ARE FOR PERMITTING PURPOSES ONLY AND ARE NOT INTENDED FOR CONSTRUCTION USE.